

REV	更改	DATE	日期	MODIFICATION	内容	DRAWN	修改
		11/05/05					

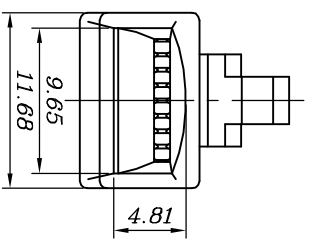

Round

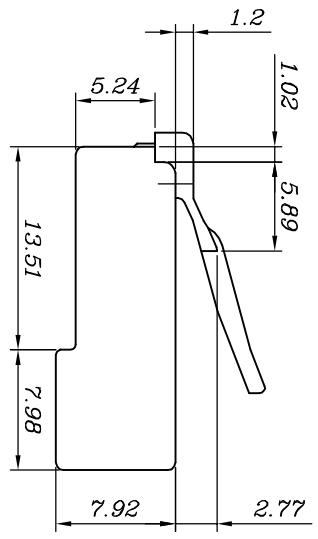
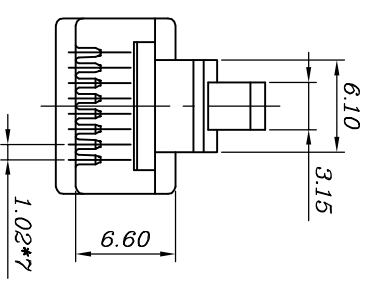
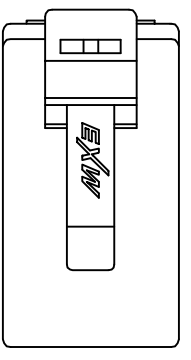
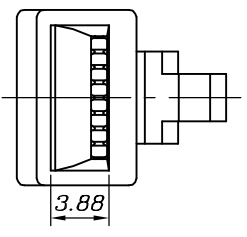

Flat

SPECIFICATIONS
 1. ELECTRICAL:
 UL APPLICATIONS: 250 VOLTS AC MAX., AT 2 AMPS.
 DIELECTRIC WITHSTANDING VOLTAGE: 500 VOLTS AC.
 INSULATION RESISTANCE: 100 MΩ.
 TERMININATION: RESISTANCE 20mΩ MAX AFTER ENVIRONMENTAL TESTING.
 2. MECHANICAL:
 CABLE-TO-PLUG TENSILE STRENGTH: 19.6N/PCS MIN.
 DURABILITY: 200 MATING CYCLES.
 3. MATERIAL & FINISH:
 HOUSING: POLYCARBONATE, UL94V-0 OR UL94V-2.
 COLOR: TRANSPARENT OR OTHER COLOR ARE AVAILABLE.
 CONTACT BLADE: PHOSPHOR BRONZE.
 CONDUCTOR: STRANDED & SOLID WIRE, 24AWG, 26 AWG.
 GOLD PLATING: 3u"~50u", ARE AVAILABLE.

规范
 1. 电器:

UL应用最大250VOLTS AC.
 介质耐电压伏特数:500VOLTS AC.
 绝缘阻抗:100百万欧姆.
 终端阻抗:在环境测试后最大可承受20微欧姆终端阻抗.

2. 机构
 拉力测试:至少19.6N/PCS.
 耐力测试:至少200次之插拔测试.

3. 材质表面处理
 塑胶壳:聚碳酸脂, UL-94V-0 or UL94V-2.
 颜色:透明,或者其他颜色亦可.
 金片:磷铜片.
 导体:多股线&单股线, 24AWG, 26AWG.
 镀金厚度:3u"~50u", 皆可提供.

客户用产品图

BLADE:

Type	E	B	Y	Z
Drawing				
Mark				

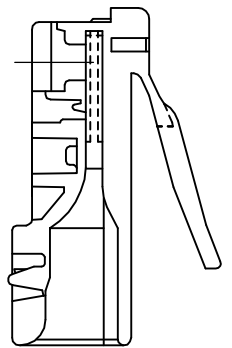
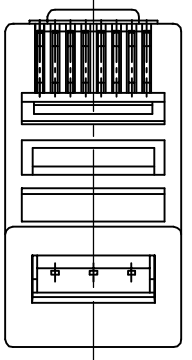

EXW 卓新工业股份有限公司
 EXCELLENCE WIRE IND.CO.,LTD

DIMENSION IN mm (Inch) TOLERANCE UNLESS OTHERWISE SPECIFIED	材 质 MATERIAL	图 号 DWG NO.
.X±0.20	PC	PLUG-009-EXW
.XX±0.10	.X°±5°	名 称 Description
	.XX°±2°	PLUG-8P
审 核 APPROVAL	核 对 CHECKED	制 图 DRAWN
		Lucia
		比 例 SCALE
		2/1
		角 法 PROJ.
		张 数 SHEET
		1/1
		更 改 REV
		A